



# Building Proposal

DESIGN | ENGINEERING | PROCUREMENT | MANAGEMENT | LOGISTICS | SUPPORT



DESIGN | ENGINEERING | PROCUREMENT | MANAGEMENT | LOGISTICS | SUPPORT



## Mitchell McAleer, here is your complete building quotation.

Quote #85679360, 4/20/2021

### Building Type

30' - 0" wide x 90' - 0" long x 10' - 0" high building with roof pitch of 1:12

### Building Options

N/A

Frame finish: Galvanized Steel

Roof finish: 26G bare

Wall finish: 26G painted

### Stamped Engineering Plans

No snow load

110 mph wind speed, exposure 'C'

2018 IBC

### Building Price

Building: \$33,910.00

Sales Tax: \$0.00

Applicable taxes will be indicated on the final invoice.

**Total Price: \$33,910.00\*\*\***

Delivery included

Pricing is valid for 7 days.

\*\*\*To avoid steel, freight or material increases, customer agrees to take delivery 5-7 weeks from order execution.

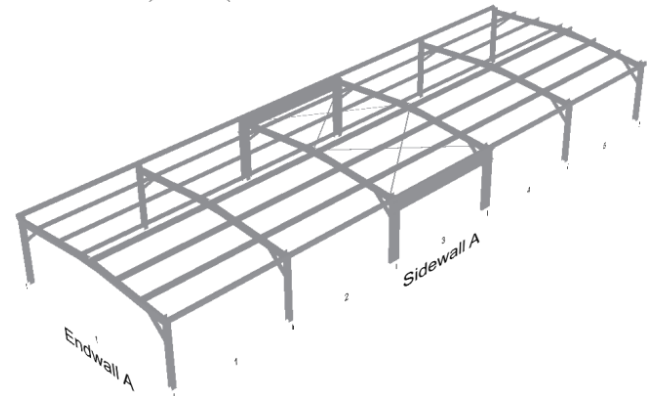
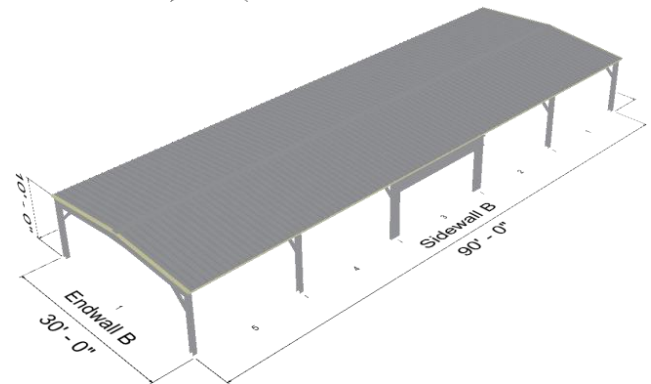
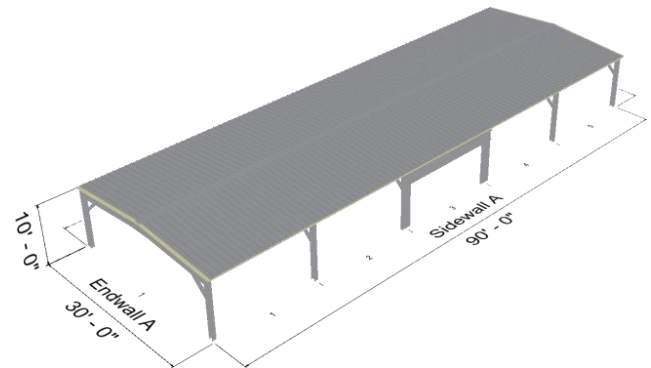

**Next Step: If you are happy with your quote and ready to lock in years of value, secure your building at the best price today by signing the following Building Component Sales Agreement**



Allied Steel Buildings
6451 N Federal HWY Fort Lauderdale FL 33308
Phone: 1-877-997-8335
Email: tgarci@alliedbuildings.com

Building Component Sales Agreement

The undersigned owner(s) jointly and severally (hereinafter referred to as "Purchaser") acting as general contractor, enter into the following Building Component Sales Agreement ("Agreement") with Allied Steel Buildings (hereafter known as "Seller") acting as subcontractor.

Conditions To Sale

- 1. Purchaser shall be solely responsible to verify and supply the Seller the correct loading design information in conformance with local building codes.
2. Purchaser is responsible for all permits, site preparation, site and construction inspection, and assembly of the building components.
3. Purchaser is responsible for any local and/or state taxes.

Building Specifications

Building Site Address:
5500 Ben Canyon Rd., San Bernardino, CA, 92407

Framing Details:
Frame Type: Galvanized Steel

Building and Site Requirement:
Ground Snow Load: N/A
Design Roof Snow Load: N/A
Wind Load/Exposure: 110 mph C
Soil Bearing Capacity: 1500 psf
Building Code: 2018 IBC
Building Occupancy Category: II
Building Heating: Heated
Extra Roof Dead Load: 3 psf
Extra Wall Dead Load: 3 psf

Sheeting and Trim Details:
Roof Type: PBR-Panel 26G Galvalume
Roof Color: Galvalume
Wall Type: PBR-Panel 26G Painted
Wall Color: Light Stone (LS)
Eave Trim/Gutter Type: Eave Trim
Trim Color: Light Stone (LS)

Building Dimensions:
Width: 30' - 0" Length: 90' - 0"
Eave Height: 10' - 0" Roof Pitch: 1:12
# Sidewall Bays: 5 # Endwall Bays: 1

Opening Details:
Personnel doors: None
Drive Doors: None
Windows: None
Framed Openings: None
Open Bays: Bay 1 in Endwall A is open
Bay 1 in Sidewall A is open
Bay 2 in Sidewall A is open
Bay 1 in Endwall B is open
Bay 2 in Sidewall B is open
Bay 1 in Sidewall B is open
Bay 5 in Sidewall B is open
Bay 4 in Sidewall B is open
Bay 3 in Sidewall B is open
Bay 3 in Sidewall A is open
Bay 4 in Sidewall A is open
Bay 5 in Sidewall A is open

Leanto A Details:
Span: N/A Bays: N/A
Drop: N/A Roof Pitch:N/A
Eave Height: N/A

Leanto B Details:
Span: N/A Bays: N/A
Drop: N/A Roof Pitch: N/A
Eave Height: N/A

Translucent Panels:None

Mezzanine Details:
Floor Height: N/A Bays: N/A
Live Load: N/A Joist Spacing: N/A

Insulation Details:
None

Extra Options:
N/A



Purchaser: Mitchell McAleer
Mailing Address: 5500 Ben Canyon Rd.
San Bernardino, CA, 92407
Phone: (909)219-0657

Total Contract Price: \$33,910.00
Down payment: \$3,391.00 (due at signing)
2nd payment: \$16,955.00 (due on delivery of plans)
Final payment: \$13,564.00 (due prior to delivery)

Proposal Acceptance

This proposal is approved and accepted by:

Purchaser

Allied Steel Buildings, Inc.

Signature

Signature

Printed Name

Date

Printed Name

Date

Signature above by purchaser indicates acknowledgement and acceptance of terms and conditions found in the following link:
http://www.alliedbuildings.com/terms/

Buyer agrees to pay balance of the total price prior to delivery of the purchased goods and acknowledges receipt of a completed copy of this purchase order. The purchase order by Buyer above named to Seller shall constitute an agreement binding upon Seller only when accepted in writing by Seller's authorized representative. The Project Manager of Seller preparing this purchase order is not an officer of Seller and not authorized to accept this order of Buyer. Upon receipt of this order, if the order is accepted, the "Acceptance" copy will be returned to Buyer, duly signed by an Authorized Representative, or if not accepted, the initial payment shall be returned to Buyer. Upon acceptance, Buyer shall not be entitled to a refund of the whole or any part of the initial payment tendered to the Project Manager of Seller. Unless delay is the result of Allied causes, delivery after the requested delivery date will necessitate that any increases in the cost of steel, materials or freight will be passed onto Buyer. Buyer will receive immediate knowledge of the cost increase through a Change Order reflecting the new price as soon as same is received by Seller. At that time, Buyer can then agree to the increase by signing the Change order or cancel the contract; but Buyer will be liable for all work performed and parts ordered up to the date of the cancellation. See the terms and conditions at www.alliedsteelbuildings.com/terms and are incorporated by this reference. Items not mentioned in this proposal, including but not limited to foundation design and anchor bolts, will not be included in the fees/pricing listed herein. Buyer hereby acknowledges receipt of a complete copy of this agreement and agrees to all the terms herein contained and as set forth in the Terms and Conditions.